

DD 12070 - 12V 7Ah - C20

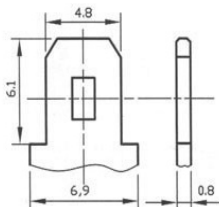

Features

- Special grid alloy and plate design
- Long service life
- High charging performance
- High gas recombination technology
- Low-self discharge characteristic
- Wide operating temperature range

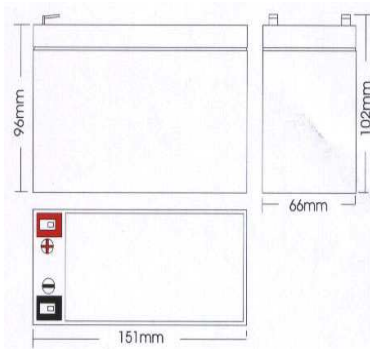

F1 Terminal

Application

- Measuring instrument
- Medical equipments
- Telephone sets
- Lighting equipment
- Security & alarm systems
- UPS power supply
- Power station and telecom station



ISO9001
ISO14000



CGZ3100705-02429-E

Specification

Cell per unit	6
Normal Voltage	12V
Normal Capacity	7Ah
Weight	Approx.2,05Kg (4,520lbs)
Internal Resistance	Approx. 22,91 mΩ
Normal Operating Temperature Range	25°C
Recommended Maximum Charging Current Limit	1,75A max
Float Charging Voltage	13,6 to 13,8VDC/unit Average at 25°C (77°F)
Equalization and Cycle Service	14,1 to 14,4VDC/unit Average at 25°C (77°F)
Self Discharge	Reddot Batteries can be stored for more than 6 months at (25°C/77°F).Please charge batteries before using. For higher temperatures the time interval will be shorter.
Terminal	F1

Characteristics

Rated Capacity	20 hour rate(0,35A)	7,0AH
	10 hour rate(0,7A)	6,5AH
	5 hour rate(1,12A)	5,6AH
	27 min rate(7A)	3,15AH
	7 min rate(21A)	2,45AH

Charging Characteristics(25°C/77°F)

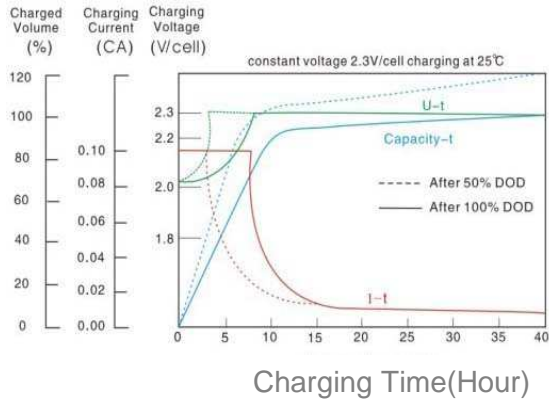

The Relation between Discharging Current and Discharging time(25°C/77°F)

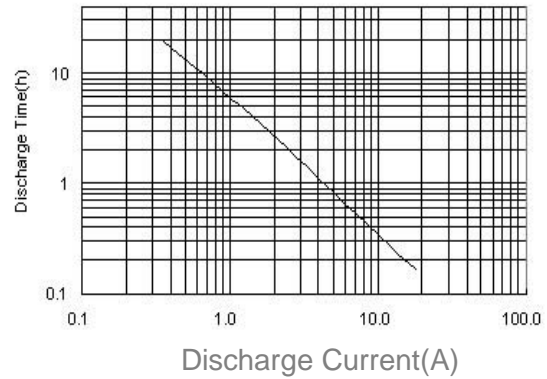

Discharging Characteristic(25°C/77°F)

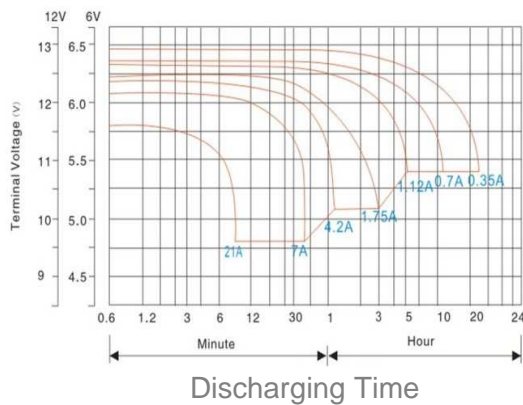

Self-Discharging Characteristic(25°C/77°F)

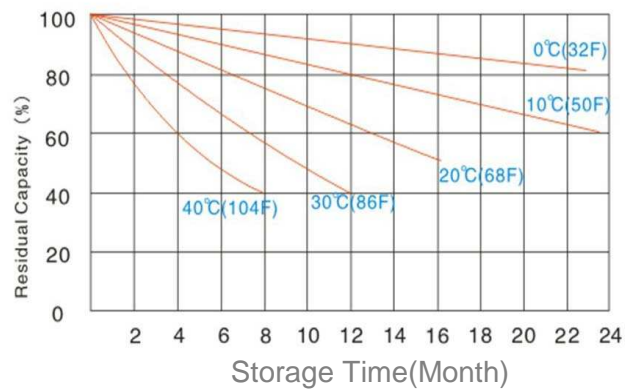

Constant Current Discharge Characteristics (Amperes at 25°C)

Cut-off Voltage/cell	5min	10min	20min	45min	1Hr	2Hr	4Hr	8Hr	10Hr	20Hr
1,70	25,9	16,9	9,42	4,89	4,20	2,49	1,42	0,810	0,663	0,357
1,75	25,7	16,7	9,33	4,84	4,17	2,40	1,38	0,800	0,657	0,354
1,80	25,4	16,5	9,24	4,79	4,14	2,30	1,35	0,790	0,650	0,350

Constant Power Discharge Characteristics (Watts at 25°C)

Cut-off Voltage/cell	5min	10min	20min	45min	1Hr	2Hr	4Hr	8Hr	10Hr	20Hr
1,70	311	203	113	58,7	50,4	29,9	17,0	9,72	7,89	4,25
1,75	308	201	112	58,1	50,1	28,8	16,6	9,60	7,82	4,21
1,80	305	198	111	57,5	49,7	27,6	16,2	9,48	7,74	4,17

All mentioned values are average values